



INTRODUCTION

Congratulations! You have purchased one of the most sophisticated cordless telephones on the market! The **Ameritech AM 1930** has been designed to offer a new standard in cordless telephone technology.

Unlike most other cordless phones, the **Ameritech AM 1930** digitizes your voice using advanced ADPCM digital voice coding to provide noise- and distortion-free performance. In most conditions, you will not be able to tell you are using a cordless phone. Gone are the annoyances of static, interference and having to listen to other people's conversations on your cordless phone.

The **Ameritech AM 1930** scrambles your voice before it transmits it. This allows you the security of knowing that no one can tune in and eavesdrop on your conversations.

The **Ameritech AM 1930** decodes and displays name and/or number Caller ID information where available and when subscribed to. The alpha-numeric display can show both the name and number of the calling party. Up to 24 name characters or 11 phone number digits can be displayed.

With the **Ameritech AM 1930**, the user can easily answer a call by pressing any key other than the OFF, MUTE or VOLUME Keys. In addition, the handset keypad and display illuminate while the handset rings to signal an incoming call. This is very useful in a dark environment.

The **Ameritech AM 1930** also provides a two-way Intercom/Handset locator function.

The **Ameritech AM 1930** uses special memory in both the base and handset which is not susceptible to power failures. This provides permanent storage of all memory dial numbers, Caller ID information, and the base and handset security codes.

When an optional battery pack is installed in the base unit, the **Ameritech AM 1930** uses this battery pack to provide operational backup in case of power failure. In this way you have access to Handset functions during a total power outage. Calls can still be placed and received on the Handset without interruption. Up to 5 hours backup will be possible with a fully charged battery pack in the base unit.

The **Ameritech AM 1930** informs you when another extension is currently in use on the same phone line. The phone will also alert you when you are Out of Range, even when you're not using the phone!

There are two dedicated Billed Services keys on the handset for your convenience. When pressed, these keys will automatically dial the appropriate keys for REPEAT DIALING, or *69 AUTO CALLBACK. There may be an access charge for these services. Contact your local telephone company for more details.





INTRODUCTION



Special Features

- 900 MHz Operation.
- Fully Digital Link between Handset and Base .
- Digitally-Scrambled Voice Communication.
- Alphanumeric Call Waiting Caller ID.
- 2 row by 12 character 5x7 dot matrix alphanumeric display.
- 50 Caller ID memory locations.
- Speakerphone with second keypad in Base Unit.
- Backlit display on the handset.
- Backlit handset keypad.
- 21 location Programmable Memory for 20 Digit Phone Number.
- 10 Channel Operation with auto channel selection.
- Out-of-Range indication while the handset is in use or in standby mode.
- Removable handset battery pack.
- Spare battery charger in the base unit.
- Battery back-up in case of power failure (with optional spare battery pack installed in base).
- Face up or Face down Handset charging.
- Easy answer - When the phone rings, simply press any key other than OFF, MUTE, or the Volume Keys on the handset to answer.
- Auto hang up when returning the handset to the base cradle.
- Extension in use indicator.
- Message waiting indicator for use with voicemail service.
- Auto line drop from HOLD when an extension phone is picked up.
- Multi-level REDIAL; stores last 5 numbers dialed.
- 24 Bit Digital Security Code.
- Tone and Pulse Dialing.
- Low Battery Detect and Warning indicator.
- Up to 7 hours continuous talk time or 7 days standby time.
- Volume Adjust on Handset and Base Unit.
- HOLD, FLASH and MUTE.
- Hearing-Aid Compatible Receiver.
- Detachable power supply.
- Non-volatile storage of security code, Caller ID and memory dial records.
- Two Billed Services function keys for REPEAT DIALING and *69 AUTO CALLBACK.

This manual is designed to make you familiar with the **Ameritech AM 1930**. We strongly recommend you read the manual before using your phone.



INTRODUCTION

Parts Checklist

1. Handset
2. Base Unit
3. Wall mounting bracket
4. AC power adapter
5. Battery pack
6. Telephone line cord

To purchase replacement battery packs, call Ameritech at 1-800-456-6858.

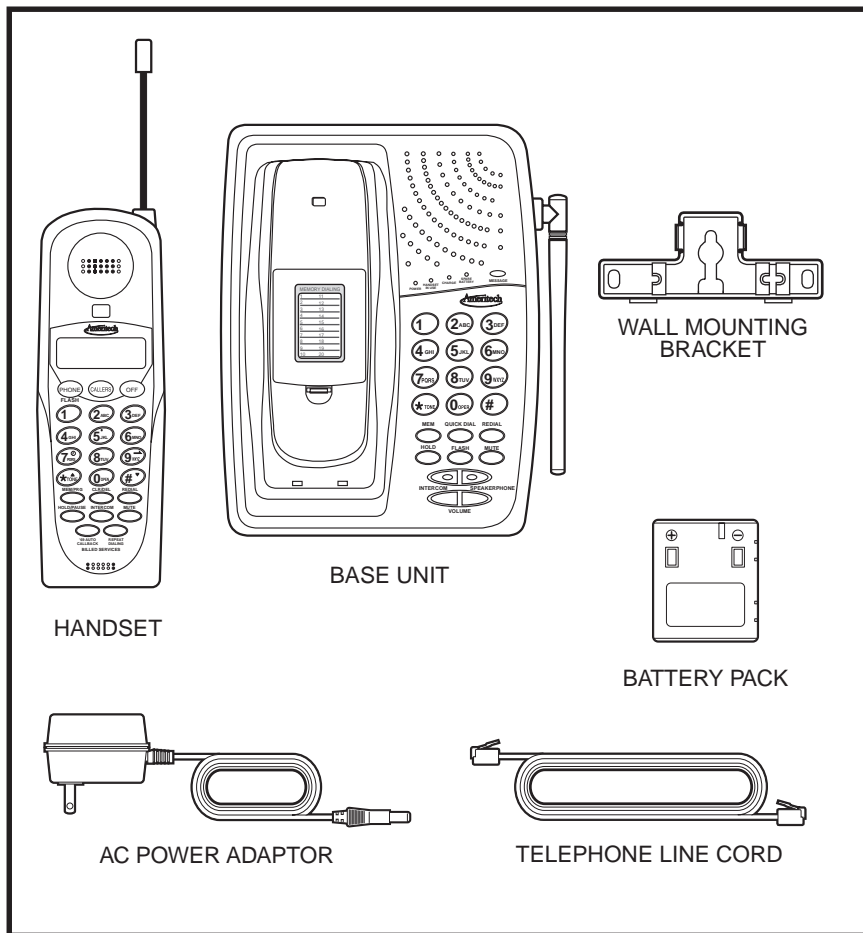



FCC Regulations

This equipment complies with Parts 15 and 68 of the Federal Communications Commission (FCC) rules for the United States. It also complies with regulations RSS210 and CS-03 of Industry and Science Canada. Operation is subject to the following two conditions: (1) this device may not cause interference, and (2) this device must accept any interference, including interference that may cause undesired operation of the device.

A label is located on the underside of the base unit containing either the FCC registration number and Ringer Equivalence Number (REN) or the Industry Canada (IC) registration number and Load Number. You must, upon request, provide this information to your local telephone company.

This equipment is compatible with inductively coupled hearing aids.

Should you experience trouble with this telephone equipment, please contact:

AMERITECH at 1-800-456-6858.

For repair/warranty information. The telephone company may ask you to disconnect this equipment from the line network until the problem has been corrected.

FCC Part 15

Warning: Changes or modifications to this unit not expressly approved by the party responsible for compliance could void the user's authority to operate the equipment.

The equipment has been tested and found to comply with part 15 of the FCC rules. These limits are designed to provide reasonable protection against harmful interference in a residential installation. This equipment generates, uses and can radiate radio frequency energy and, if not installed and used in accordance with the instructions, may cause harmful interference to radio communications. However, there is no guarantee that interference will not occur in a particular installation. If this equipment does cause harmful interference to radio or television reception, which can be determined by turning the equipment off and on, the user is encouraged to try and correct the interference by one or more of the following measures:

- Reorient or relocate the receiving antenna.
- Increase the separation between the equipment and receiver.
- Connect the equipment into an outlet or on a circuit different from that to which the receiver is connected.
- Consult the dealer or an experienced radio/TV technician for help.





FCC Regulations

FCC Part 68

The FCC requires that you connect your cordless telephone to the nationwide telephone network through a modular telephone jack (USOC RJ11C, RJ11W or RJ14).

Your telephone company may discontinue your service if your equipment causes harm to the telephone network. They will notify you in advance of disconnection, if possible. During notification, you will be informed of your right to file a complaint with the FCC.

Occasionally, your telephone company may make changes in its facilities, equipment, operation, or procedures that could affect the operation of your equipment. If so, you will be given advance notice of the change to give you an opportunity to maintain uninterrupted service.

The base unit contains no user serviceable parts. The handset contains a user replaceable battery pack.

If it is determined that your telephone equipment is malfunctioning, the FCC requires that it not be used and that it be unplugged from the modular jack until the problem has been corrected. Repairs to this telephone equipment can only be made by the manufacturer or its authorized agents or by others who may be authorized by the FCC. For repair procedures, follow the instructions outlined under the manufacturer's Limited Warranty.

This equipment may not be used on coin service provided by the phone company or Party Lines.

The REN is useful in determining the number of devices you may connect to your telephone line and still enable the devices to ring when you receive a call. The general rule is that the REN value should not exceed 5.0A total; however, contact your local telephone company for the specific number in your area.

Your **Ameritech AM 1930** is designed to operate at the maximum power allowed by the FCC. This means your handset and base unit can communicate only over a certain distance - which will depend on the location of the base unit and handset, weather, and the construction and layout of your home or office.





IMPORTANT SAFETY INSTRUCTIONS

When using your telephone equipment, basic safety precautions should always be followed to reduce the risk of fire, electric shock and injury to persons, including the following:

1. Read and understand all instructions.
2. Follow all warnings and instructions marked on the product.
3. Unplug this product from the wall outlet before cleaning. Do not use liquid cleaners or aerosol cleaners. Use a damp cloth for cleaning.
4. Do not use this product near water (for example, near a bath tub, kitchen sink, or swimming pool).
5. Do not place this product on an unstable cart, stand, or table. The product may fall, causing serious damage to the product.
6. Slots and openings in the cabinet and the back or bottom are provided for ventilation. To protect it from overheating, these openings must not be blocked by placing the product on the bed, sofa, rug, or other similar surface. This product should never be placed near or over a radiator or heat register. This product should not be placed in a built-in installation where proper ventilation is not provided.
7. This product should be operated only from the type of power source indicated on the marking label. If you are not sure of the type of power supply to your home, consult your dealer or local power company.
8. Do not allow anything to rest on the power cord. Do not locate this product where the cord will be abused by persons walking on it.
9. Never push objects of any kind into this product through cabinet slots as they may touch dangerous voltage points or short out parts that could result in a risk of fire or electric shock. Never spill liquid of any kind on the product.
10. To reduce the risk of electric shock, do not disassemble this product, but Call Ameritech Telephones at 1-800-456-6858. Opening or removing cabinet parts other than specified access doors may expose you to dangerous voltages or other risks. Incorrect reassembling can cause electric shock when the appliance is subsequently used.
11. Do not overload wall outlets and extension cords as this can result in the risk of fire or electric shock.





CTIONS

IMPORTANT SAFETY INSTRUCTIONS

12. Unplug this product from the wall outlet and refer servicing to Ameritech Telephones at 1-800-456-6858 under the following conditions:
- A. When the power supply cord or plug is damaged or frayed.
 - B. If liquid has been spilled into the product.
 - C. If the product has been exposed to rain or water.
 - D. If the product does not operate normally by following the operating instructions. Adjust only those controls that are covered by the operating instructions, because improper adjustment of other controls may result in damage and will often require extensive work by an authorized technician to restore the product to normal operation.
 - E. If the product has been dropped and the cabinet has been damaged.
 - F. If the product exhibits a distinct change in performance.
13. Avoid using a telephone (other than a cordless type) during an electrical storm. There may be a remote risk of electric shock from lightning.
14. Do not use the telephone to report a gas leak in the vicinity of the leak.



SAVE THESE INSTRUCTIONS





REPLACING THE BATTERY PACK

Charging The Handset Battery Pack

The handset of your **Ameritech AM 1930** cordless telephone is powered by a rechargeable battery pack. It charges automatically whenever the handset is in the base. You should charge the battery pack for 16 hours when you first receive your phone. You'll know the battery pack needs charging when:

- The phone emits a warning tone when you press the PHONE key.
- The low battery message is displayed:



- The handset seems completely dead, the display is clear and the handset does not beep when you press the keys.

To Charge The Battery Pack

To charge the battery pack, place the handset in the base unit. The CHARGE indicator will light to show the handset is seated properly and the battery pack is charging. It is recommended that the battery pack be charged for at least 16 hours initially and 8 hours for maintenance charging. You can use your telephone before that with diminished capacity, but it is best to charge the battery pack fully. It will take several recharge cycles to maximize the charge capacity of your battery pack. The maximum battery life between charges is 7 hours of continuous talk time or 7 days of stand-by.

Alternatively, if you have purchased a spare battery pack and it has been charging in the base unit, simply exchange the drained handset battery pack with the fully charged replacement battery pack from the base charger. Place the drained handset battery pack into the base charger to recharge.

The base spare battery charger does NOT charge a battery pack as quickly as the handset battery charger. A full charge requires 24 hours when using the spare battery charger.

It's Impossible To Overcharge The Battery Pack

The battery pack can be recharged many times, but if you get a low battery message even after 16 hours of charging in the base cradle (or 24 hours in the base spare battery charger), the battery pack(s) should be replaced.

To purchase replacement battery packs, call Ameritech at 1-800-456-6858.

A Word About Rechargeable Batteries

Your NiCad battery pack recharges whenever the Handset is returned to the Base Unit cradle. You may return the Handset to its cradle whenever you're not using the phone.





REPLACING THE BATTERY PACK

To Replace The Handset Battery Pack Follow The Steps Below:

1. Remove the battery case cover by pressing on the concave and sliding downward.

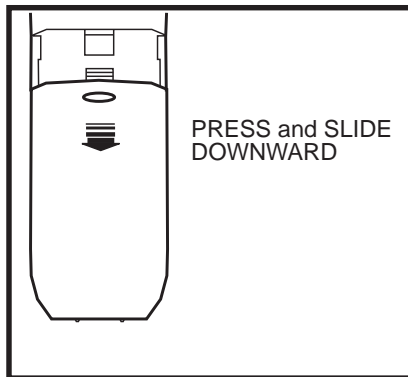

2. Discard the old battery pack. Don't put the old battery pack in a trash compactor or a fire - it could burst.
3. Place the new battery pack in its housing with the metal contacts facing down.

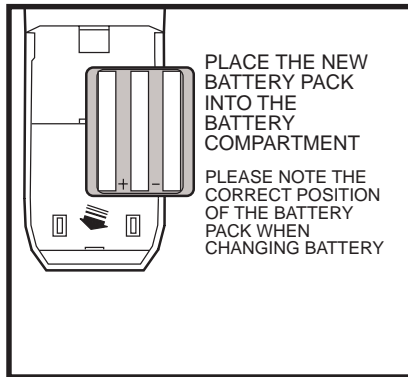

4. Replace the battery case cover by sliding the cover upwards.

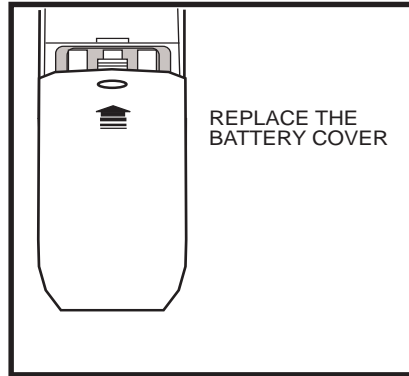

5. If the new battery pack is not already charged, place the handset in the cradle of the base unit to allow it to charge for 16 hours.

CAUTION:

To reduce the risk of fire or injury to persons, read and follow the instructions

1. Use only battery 80-4134-00-00 pack.
2. Do not dispose of the battery in a fire. The cell may explode.

IMPORTANT:

Do not dispose of this battery into household garbage. For information on recycling or proper disposal, consult your local solid waste collection or disposal organization.

3. Do not open or mutilate the battery. Released electrolyte is corrosive and may cause damage to the eyes or skin. It may be toxic if swallowed.
4. Exercise care in handling batteries in order not to short the battery with conducting materials such as



REPLACING THE BATTERY PACK

rings, bracelets, and keys. The battery or conductor may overheat and cause burns.

To purchase replacement battery packs, call Ameritech at 1-800-456-6858.

Spare Battery Charger

The **Ameritech AM 1930** has a built-in spare Battery Charger, which is located in the cradle of the Base Unit.

NOTE:

In order to benefit from this feature, you must obtain an optional Spare Battery from an authorized dealer, or by contacting Ameritech at 1-800-456-6858.

Installation

Remove the Spare Battery charger cover by pressing the release tab and lifting up.

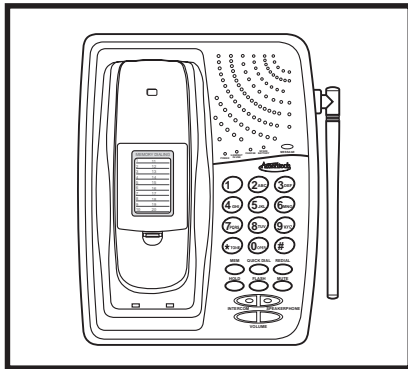

Place a battery pack in the Spare Battery charger. Make sure the metal charging contacts on the underside of the battery pack are aligned with the charging contacts in the Spare Battery charger.

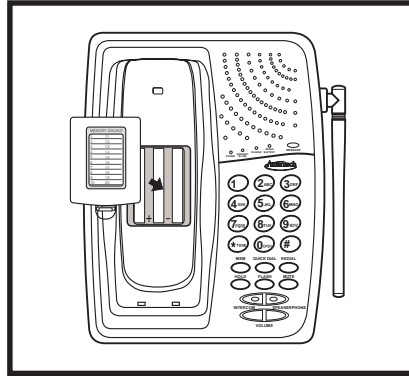

Power Backup

When a Spare Battery pack is installed in the Base Unit, the **Ameritech AM 1930** uses this battery pack to provide operational backup in case of a power failure. If you have a fully charged battery pack in the Spare Battery pack charger and there is a power outage, you will still be able to place and receive calls on the Handset for up to five hours.

Note:

During Power Backup mode the Base Unit telephone functions are not operable. In addition, Caller ID information may not be reliable.

Replacing a Drained Handset Battery

The Spare Battery pack can also be used to replace a drained Handset battery pack to ensure uninterrupted use. Be sure to put the drained battery pack in the Spare Battery charger for recharging.

Please note that the Spare Battery compartment charges at a slower rate than a battery pack charging in the Handset. It takes 24 hours to fully charge a battery pack in the Spare Battery charger.

GETTING STARTED

Setting Up Your Ameritech AM 1930

Choose an area near an electrical outlet and a telephone wall jack.

AC Power Adapter

Plug the AC power adapter into an electrical outlet and the DC connector to the back of the base unit.

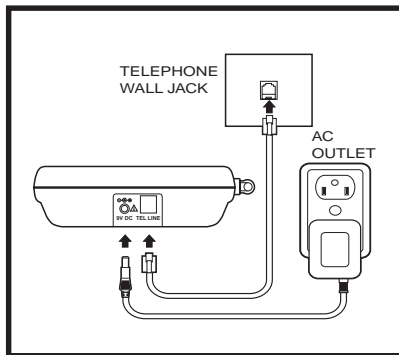

CAUTION:
Use only CLASS 2 9V DC POWER SUPPLY included with your phone.

Handset Ringer

The handset ringer is programmed ON as the factory default setting. Refer to **PROGRAMMING THE RINGER** (p.26) for more information.

Setting the Tone/Pulse Switch

The **TONE/PULSE** switch is located on the bottom of the base unit and is factory set to **TONE**. If you have touch tone service, do not change the switch setting. If you have rotary (Pulse) service, set the switch to **PULSE**.

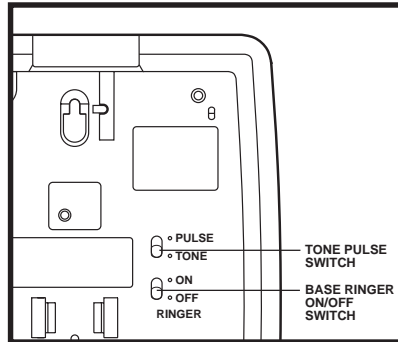

Charge the handset battery pack before use. The battery pack recharges automatically whenever the handset is in the base unit. The batteries must be charged for 16 hours before using your phone for the first time.

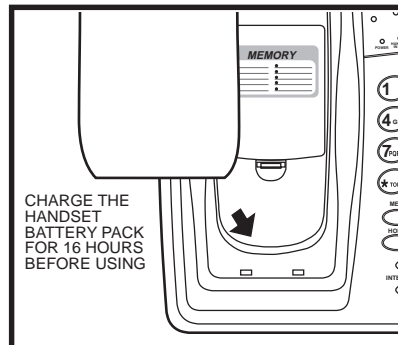

Connect Telephone Line Cord

Plug one end of the telephone cord into a wall jack and the other end into the back of the Base Unit.



GETTING STARTED

Check for a dial tone. After the battery pack is charged, rotate the Base Unit antenna to an upright position. Pick up the Handset and press **(PHONE)**, "HANDSET ON" will appear on the display, and you will hear a dial tone. If not, see 'IN CASE OF DIFFICULTY'.

Fill in the telephone number card on the base unit.

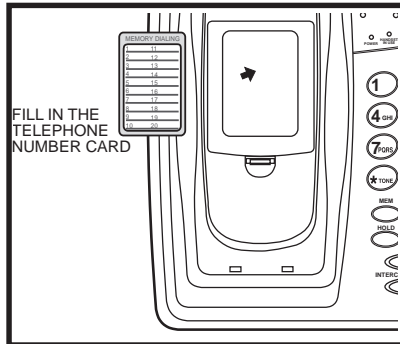

CAUTION:

1. Never install telephone wiring during a lightning storm.
2. Never install telephone jacks in wet locations unless the jack is specifically designed for wet locations.
3. Never touch uninsulated telephone wires or terminals unless the telephone line has been disconnected at the network interface.
4. Use caution when installing or modifying telephone lines.



WALL MOUNTING

The Wall Mounting bracket is designed to fit on standard Wall Mounting plates.

1. Choose a spot near an electrical outlet and a telephone jack.

Your phone requires a modular telephone jack and a standard electrical outlet (120v AC). The power cord is six feet long; make sure there is an electrical outlet within reach of the base. The outlet should not be controlled by a wall switch. If the switch is ever turned off, the phone will not operate.

2. Position the wall mounting bracket on the base.

Line up the tabs on the wall mounting adapter with the holes on the bottom of the base (Figure 1). Snap the wall mounting bracket firmly in place.

3. Mount the base on the wall.

Position the base so the mounting studs will fit into the holes on the bottom of the base. Position the power cord to extend down the wall the phone is to be mounted on. Slide the base down on the mounting studs until it locks into place.

4. Connect the telephone line cord.

The telephone line cord has a snap-in plug at each end. Insert one of the plugs into the jack on the back of the base. Insert the other end of the plug into the wall jack.

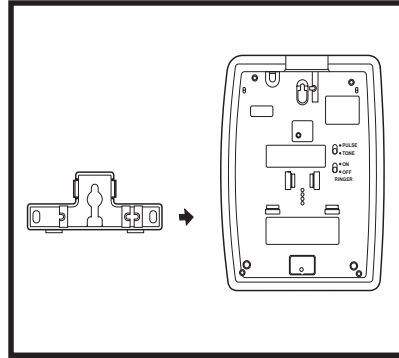

Figure 1

5. Plug the AC adapter into an electrical outlet and the DC connector into the power jack located on the back of the Base Unit . (Figure 2)

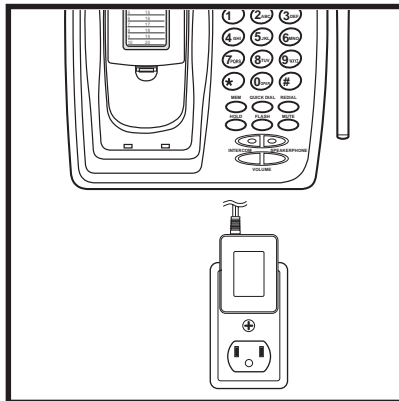

Figure 2



EXAMPLES OF THE HANDSET DISPLAY



ABCDEFGHIJKLM
1234567890

Handset Display Messages



HANDSET ON

HANDSET ON is displayed when the handset is in use.



VOLUME 

After pressing a volume key, this displays the current volume setting.



LOW BATTERY

This display warns of a low battery condition. The handset typically operates for at least 5 minutes after the low battery indication first appears.



BASE PAGING
HANDSET

This message is displayed when the Base Unit pages the handset.



LINE ON HOLD

This message is displayed when the handset is on hold.



CHECK TEL.
LINE

This message is displayed when the live telephone line is not connected to the base unit.



MICROPHONE
MUTED

This message is displayed when the handset microphone has been muted.



HANDSET
RINGER OFF

This message is displayed when the handset ringer has been programmed off.



CHANNEL
SEARCHING ...

This display warns that the handset has lost communication with the base unit and is attempting to reestablish a link by scanning all channels.



EXAMPLES OF THE HANDSET DISPLAY

FOUND
CHANNEL X

This display confirms that a communication link has been established with the Base.

EXTENSION
IN USE

This message is displayed while in OFF mode, if another phone is currently using the same line.

HANDSET ON
WITH BASE

This message is displayed when both the handset and base unit are on a call together.

CHECK AC PWR

This display warns when an AC power failure has occurred and power is being supplied by an optional spare battery pack.



THE HANDSET LAYOUT

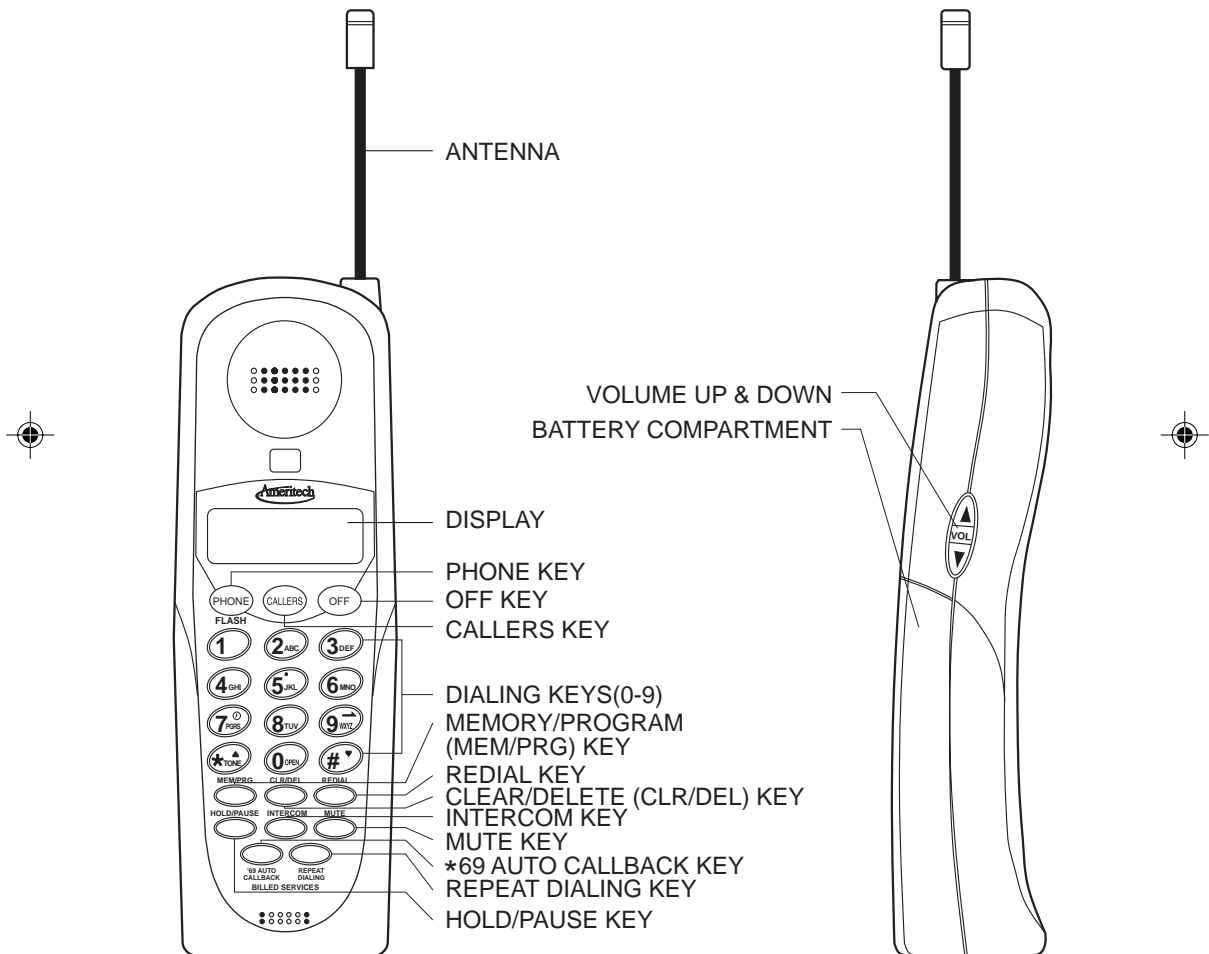



THE BASE UNIT LAYOUT

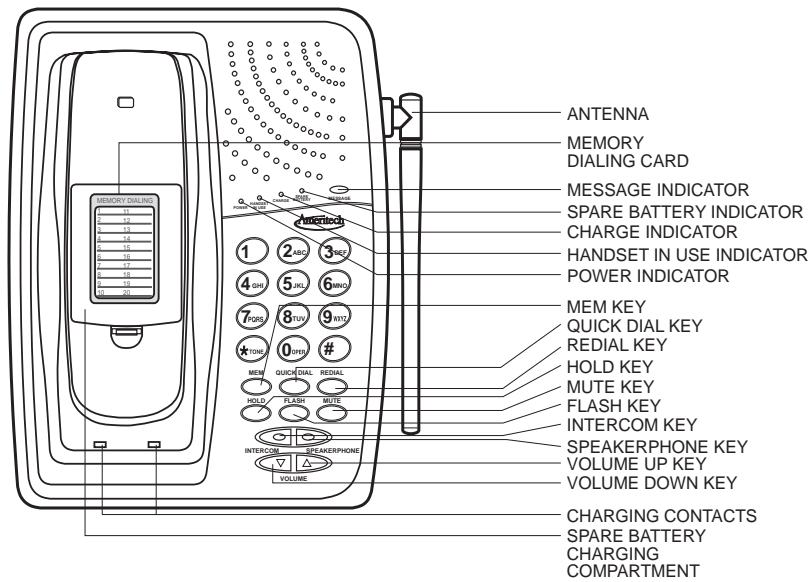
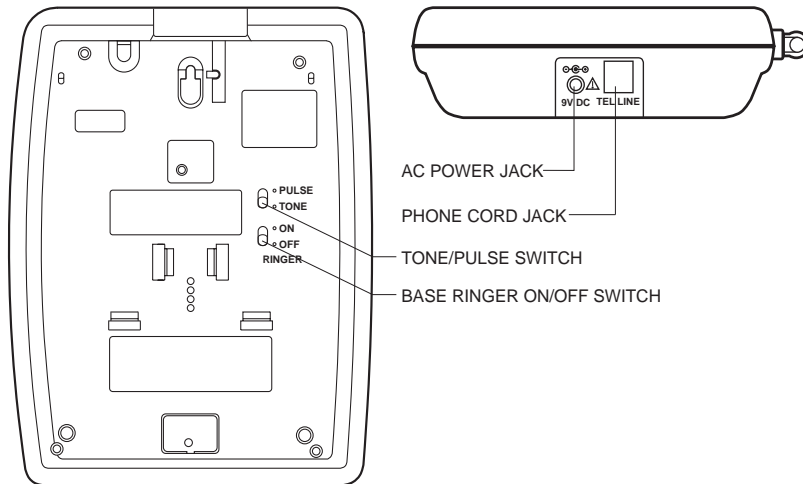



BASE UNIT FEATURES

POWER Indicator

Glow when the power supply is plugged in and power is applied to the Base Unit.

HANDSET IN USE Indicator

Glow when the Handset has been activated.

CHARGE Indicator

Glow when the Handset is placed in the Base Unit cradle. If there is no battery pack in the Handset, the **CHARGE indicator** will flash slowly.

SPARE BATTERY Indicator

Glow when an optional battery pack is installed in the Base Unit charger.

HOLD Indicator

Glow when an active call is placed on **HOLD**.

MUTE Indicator

Glow when the Base Unit **MUTE** key is pressed during an active call.

INTERCOM Indicator

Glow when the Base Unit is in **INTERCOM** mode with the Handset.

SPEAKERPHONE Indicator

Glow when the Base Unit Speakerphone is active.

Flashes slowly to indicate that an extension phone is in use.

Flashes in cadence with the incoming ring.

MESSAGE WAITING Indicator

Flashes slowly to indicate that new (unplayed) messages are stored in your Voicemail.





BASE UNIT FUNCTION KEYS

SPEAKERPHONE Key

Press this key to either initiate or answer a call from the Base Unit Speaker. Press it again to terminate your call.

Volume Keys

Press the appropriate key to raise or lower the Speakerphone volume level. Holding down the key will continuously raise or lower the volume. There are a total of **8** volume levels.

Base Ringer ON/OFF Switch

Located on the bottom of the Base Unit, this switch controls the Base Unit ringer. It has no effect on the Handset ringer.

TONE/PULSE Switch

Located on the bottom of the Base Unit. Set this switch consistent with your local phone system. In most cases, the appropriate setting is **TONE**.

MEM Key

Press this key to enter Memory (Speed) Dialing Mode.

QUICK DIAL Key

Press this key to dial the contents of memory location **#00**. The Base speakerphone can be either ON or OFF to use this feature.

REDIAL Key

Press this key to redial the last number you dialed from the Base Unit. This feature is independent of the Handset redial feature.

HOLD Key

Press this key to place your Speakerphone call on hold. Press either **(HOLD)** or **(SPEAKERPHONE)** to return to the call.

With a Speakerphone call on **HOLD**, picking up an extension phone, or activating the **Ameritech AM 1930** Handset will turn the Speakerphone OFF.

FLASH Key

During a Speakerphone call, press this key to flash the line. The feature is commonly used in conjunction with Call Waiting.

MUTE Key

Press this key to mute the Base Unit microphone during a Speakerphone call. Press **(MUTE)** again to return to the 2-way conversation.

INTERCOM Key

Press this key to Page the Handset. The Handset will ring 5 times. The Handset user can respond by pressing **(INTERCOM)**. The Handset and Base Unit have now entered 2-way INTERCOM mode.

Press **(INTERCOM)** to terminate INTERCOM mode.

This feature is also useful as a Handset locator in the event it is misplaced.



QUICK REFERENCE GUIDE

Setup Adapter

- Plug AC adapter into a standard electrical outlet and Base Unit.
- Set **TONE/PULSE** switch to **PULSE** or **TONE**. The unit is factory set to **TONE**.
- Let the handset battery pack charge for 16 hours before first use.
- Connect telephone line cord to base unit and telephone jack.

Making Calls

- Press the **PHONE** key. When **HANDSET ON** is displayed and you hear a dial tone, dial the number.
- OR
- Enter the number to be dialed on the display and then press the **PHONE** key.
- OR
- Press **SPEAKERPHONE** on the Base Unit, then dial the number.

Answering Calls

- To answer a call, press any key other than **OFF**, **MUTE**, or the Volume Keys. The handset will NOT auto-answer when lifted off the base cradle.
- OR
- Press **SPEAKERPHONE** on the Base Unit.

Hanging Up

- Press **OFF** or place the handset in the cradle to hang up a call.

To Place A Call On Hold

- Press **HOLD/PAUSE** on the Handset or **HOLD** on the Base Unit to place an active call on **HOLD**.

- To return to the call on the Handset, press either **PHONE** or **HOLD/PAUSE**.

- To return to the call on the speakerphone, press either **HOLD** or **SPEAKERPHONE**.

To Mute A Call

- Press **MUTE** to disable the Handset or Base Unit microphone.
- Press **MUTE** again to return to normal two way conversation.

To Page The Handset

- To page from the base, press **INTERCOM**.
- To cancel the **PAGE** either press **INTERCOM** again on the base or press **OFF** on the handset.

STORING MEMORY (SPEED) DIAL NUMBERS:

- The phone should be **OFF**.
- Enter the number you wish to store on the display up to a maximum of 20 digits.

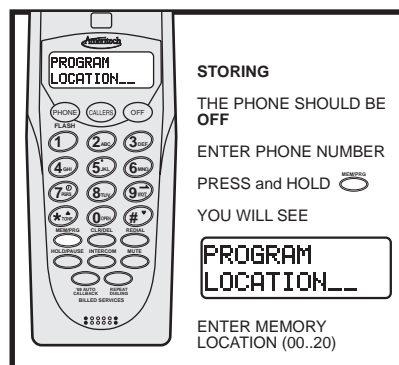

QUICK REFERENCE GUIDE

- Press and hold **MEM/PRG**. The handset will display PROGRAM LOCATION.
- Enter a two digit memory location (00..20). The unit will store the number, emit a warbled tone to confirm successful programming and exit program mode.

Memory Dialing (speed Dialing):

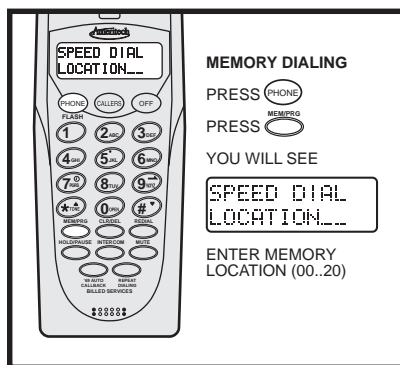

From the Handset

- Press the **PHONE** key.
- Press **MEM/PRG**.
- Enter the memory location of the phone number you wish to dial (01...20). The number will be dialed.

From the Base Unit

- Press the **SPEAKERPHONE** key.
- Press **MEM**.
- Enter the memory location of the phone number you wish to dial (00..20). The number will be dialed automatically. The number stored

in memory location 00 can also be dialed simply by pressing the QUICK DIAL key on the Base Unit.

Caller ID

- To view information stored in Caller ID memory, press **CALLERS** on the handset.
- The display will show the most recent call received.

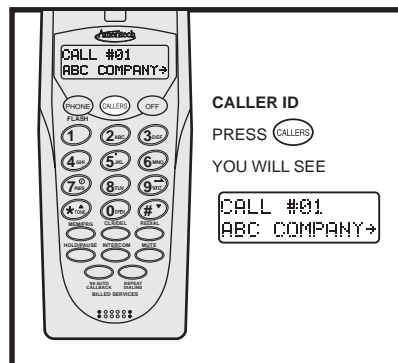

- To view the time and date of the call press and hold the 7 key. The time and date will be shown along with the phone number. For example :



- To view other calls, scroll backwards and forwards by using the **▲ (*)** and **▼ (#)** keys.
- To view additional name characters not shown on the display, press and hold the **▲ (9)** key
- To exit press **OFF**.



QUICK REFERENCE GUIDE

Using REDIAL

From the Handset:

- Press the **PHONE** key, then **REDIAL** to automatically redial the last number you dialed.

Or

- Press **REDIAL** to view the most recent telephone number dialed. To view the other phone numbers stored in REDIAL memory, press the scroll keys **▲** (*****) and **▼** (**#**). Once you have found the number you wish to dial, press **PHONE**.

From the Base Unit :

- Press the **SPEAKERPHONE** key, then **REDIAL**.

HOLD

From the Handset :

- Press **HOLD/PAUSE** to put a call on hold.
- To return to the call, press **HOLD/PAUSE** or the **PHONE** key.

From the Base Unit :

- Press **HOLD** to put a call on hold.
- To return to the call, press **HOLD** or the **SPEAKERPHONE** key.

BASIC OPERATION

Making Calls

From the Handset:

Press the **PHONE** key and wait for dial tone. Then dial the number you want.

Or

Enter the number onto the display first, then press the **PHONE** key. This will dial the number that is displayed on the display after 2 seconds. See **ADVANCED DIALING**.

If you make a mistake when dialing, press **OFF** to hang up, then press the **PHONE** key to get the dial tone again.

From the Base Unit:

- Press the **SPEAKERPHONE** key and wait for dial tone. Then dial the number you want.

Disconnecting

To end a call, either place the handset back in the base, press **OFF** on the handset, or press **SPEAKERPHONE** on the Base Unit (for speakerphone calls).

Answering Calls

From the Handset:

Press any key other than **OFF**, **MUTE** or the VOLUME keys to answer your call.

From the Base:

Press the **SPEAKERPHONE** key.

VOLUME Controls-Handset

The volume controls for the handset are located on the side of the unit. Press the **▲** (up) or **▼** (down) key

to increase or decrease the volume. Holding either key down will continuously change the volume setting. The earpiece volume level indicator on the display will change accordingly. There are four volume levels.

FLASH

You can use your **Ameritech AM 1930** cordless phone with services such as Call Waiting. Simply press the **PHONE** key to FLASH the line.

REDIAL

To **REDIAL** the last number you dialed, press the **PHONE** key, then press **REDIAL**. The phone will automatically dial the number. The number will be shown on the display.

Clearing The Display

The display can be cleared when phone off by pressing and holding the key **CLR/DEL** down until the display clears.

MUTE

- Press **MUTE** during an active call to disable the microphone.
- Press **MUTE** again to return to normal operation.

Ringer MUTE

- Press **MUTE** during incoming ringing to disable the ringer for the duration of the call.

HOLD

- Press **HOLD/PAUSE** on the Handset or Base Unit to place an active call on hold
- To return to the call on the Handset, press either **PHONE** or **HOLD/PAUSE**.
- To return to the call on the Speakerphone, press either **HOLD** or **SPEAKERPHONE**.



BASIC OPERATION

With a Handset call on hold, picking up an extension phone, or activating the **Ameritech** Speakerphone will turn the Handset OFF.

With a Speakerphone call on hold, picking up an extension phone, or activating the **Ameritech** Handset will turn the Speakerphone OFF.

To transfer a call from the Handset to Base Unit Speakerphone first place the Handset call on hold, then press **(SPEAKERPHONE)** on the Base Unit.

To transfer a call from the Base Unit Speakerphone to the Handset, first place the Speakerphone call on hold, then press **(PHONE)** on the Handset.





ADVANCED FUNCTIONS

Call Waiting

CALL WAITING is a subscription service, available from most local telephone service providers. Contact your provider for details. While you are on a call, you will hear an alert signal, warning that a second caller is trying to reach you.

If you subscribe to this service linked with CALLER ID, the name and/or phone number of the second caller can be displayed on the handset immediately after hearing the CALL WAITING alert. For more details, see **Caller ID** (p.32).

Switching calls using FLASH

- From the Handset: press the **PHONE** key to switch to the new call. To switch back press **PHONE** again.
- From the Base Unit: press the **FLASH** key to switch to the new call. To switch back press **FLASH** again.

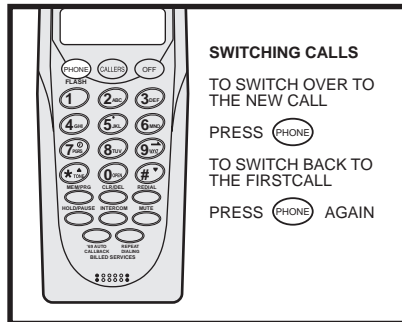

Message Waiting

Your **Ameritech** is capable of detecting a Visual Message Waiting Indication, generated by many phone service providers. If you subscribe to Voicemail service from your local telephone company, and Visual Message Waiting Indication is provided, the **Ameritech** will display the following data to alert you to new, unplayed messages:



Simultaneously, the Message Waiting indicator on the Base will flash slowly. Once you have reviewed your new messages, the **MSG. WAITING** indication on the handset, and the Message Waiting indicator light on the Base will be cleared.

You can temporarily clear the Message Waiting screen. With the Handset in the OFF mode.

Press and Hold **CLR/DEL** until the handset displays :



Press **CLR/DEL** to confirm your decision.

Pressing any key other than **CLR/DEL** will cancel the operation.



ADVANCED FUNCTIONS

The Message Waiting indication alert may reappear, as long as unplayed messages remain in your Voicemail box.

NOTE:

Message Waiting works in conjunction with Voicemail service from many local phone companies. This is an optional service. You are not required to subscribe to it.

Temporary TONE

If you have rotary (**PULSE**) telephone service (switch is set to **PULSE**), this feature allows you to temporarily switch to **TONE** dialing for such purposes as remote access to answering machines, bank-by-phone services, use of calling cards and other special services.

First, dial the call normally. Then activate the Temporary Tone feature by pressing (**TONE**) (the * key). You can then press the numbers or symbols you need, and your phone will send the proper signals.

To end the call, press (**OFF**) or place the handset back in the base. If using the speakerphone, press (**SPEAKERPHONE**) to end the call. The phone will automatically go back to rotary (**PULSE**) service.

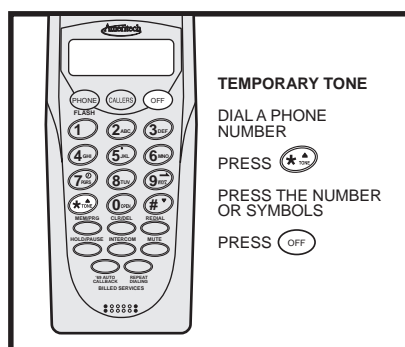

Programming The Ringer

The Handset and Base Unit ringers are capable of four different types of ringer tones. The following sections detail how to select different ringer types and how to turn off the ringer.

Changing Ringer Types

To program, the Handset must be OFF.

To select a different ringer type for the **Handset Ringer** do the following:

Press and hold: (**MEM/PROG**)
The display will show the following:

PROGRAM
LOCATION__

Press : (#)

The display will show the following:

? : 1=HANDSET
2=BASE

Press : (1)

The display will show the following:

HANDSET
RINGER X

Press : 1 for ringer type 1
2 for ringer type 2
3 for ringer type 3
4 for ringer type 4
0 for ringer type OFF

Press (**OFF**) TO exit.



ADVANCED FUNCTIONS

To select a different ringer type for the Base Unit do the following:

Press and hold : **MEM/PRG**

The display will show the following :



PROGRAM
LOCATION...

Press : **#**

The display will show the following:



? : 1=HANDSET
2=BASE

Press : **2**

The display will show the following:



BASE
RINGER X

Press : 1 for ringer type 1
2 for ringer type 2
3 for ringer type 3
4 for ringer type 4

Press **OFF** TO exit.

To turn the Base Unit ringer OFF, use the switch located on the underside of the Base Unit.

ADVANCED FUNCTIONS

Clear/Delete (CLR/DEL) Key

The **CLEAR** and **DELETE** functions can be accessed separately depending on how long the key is held down. For example, to clear the last digit entered on the display, press the **(CLR/DEL)** key for less than 1 second. Press and hold the **(CLR/DEL)** key for more than 1 second to completely clear the display.

The delete function is also used to delete Caller ID records, memory dial records, and Message Waiting indication. See **DELETING STORED NUMBERS** (p.31), and **MESSAGE WAITING** (p.25).

The handset must be OFF to perform a **CLEAR** or **DELETE** function.

Advanced Dialing

There are two different ways to dial a number from the Handset

1. Press the **(PHONE)** key and wait for a dial tone. Then dial the number you want either manually, using **MEMORY (MEM)** dialing, **Caller ID** dialing or **REDIAL**.
2. Enter the number you wish to dial on the display first. Then press the **(PHONE)** key. This will dial the number which is displayed on the display after 2 seconds.

NOTE:

The phone will dial any number which is shown on the display. If you do not want to dial the number shown on the display, it can be changed by:

- Press and hold **(CLR/DEL)** until the display is cleared, then dial normally.
- Press **(OFF)** and start over.

Multi Level REDIAL

The **Ameritech AM 1930** stores the last five calls dialed in a special REDIAL memory.

With the Handset OFF, press **(REDIAL)**. The Handset will display the most recent telephone number you dialed:



REDIAL #01
5035551212

To view the other phone numbers stored in the special REDIAL memory, press the scroll keys **▲ (*)** and **▼ (#)**. Once you have found the number you wish to dial, press **(PHONE)**. After a 2 second pause, the number will be dialed.



ADVANCED FUNCTIONS

Billed Services

There are two pre-programmed Billed Services keys on the handset of the **Ameritech AM 1930**. These two keys are included to provide easy access to the following features:

- REPEAT DIALING
- *69 AUTO CALLBACK

It is important to note that a fee will be charged to your monthly phone bill whenever either of these services are used. For specific information about rates, please contact your local telephone company.

In order to use one of the Billed Services keys, do the following:

- Press either the **REPEAT DIALING** or ***69 AUTO CALLBACK** keys. The phone will automatically access dial tone and then send the appropriate signals. Simultaneously, the handset will display one of the following messages:

for REPEAT DIALING



or



for *69 AUTO CALLBACK.

*69 AUTO CALLBACK

For a fee, the *69 AUTO CALLBACK key speed dials the last person who

called you, whether you answered the call or not. A charge is added to your phone bill each time you use the *69 AUTO CALLBACK key. This works the same as dialing *69 on any phone.

You can also subscribe to Automatic Callback from Ameritech for a monthly fee with unlimited monthly usage. If you subscribe, you are not charged separately each time you use the service.

If your local phone company is not Ameritech, contact your phone company for information on this service.

REPEAT DIALING

For a fee, the REPEAT DIALING key tries repeatedly to connect you with the last number you dialed. For example, if you dial a number that's busy, you can press OFF, then REPEAT DIALING, then OFF. For up to 30 minutes, the service will keep trying to reach the number until it's available. When the number is available, your phone will ring; press **PHONE** and you will hear the other line ringing. Each time you use this service, a charge appears on your phone bill.

You can also subscribe to Repeat Dialing from Ameritech for a monthly fee with unlimited monthly usage. If you subscribe, you are not charged separately each time you use the service.

If your local phone company is not Ameritech, contact your phone company for information on this service.

To cancel Repeat Dialing before the 30 minutes are over, dial *86.



MEMORY DIALING

Storing Memory (Speed) Dial Numbers

To program a speed dial location, do the following:

- With the Handset **OFF**, enter the telephone number you wish to store (20 digits maximum).
- Enter program mode by pressing and holding **(MEM/PRG)**. The display will show the following:



PROGRAM
LOCATION__

- Enter the memory location (00..20) you wish to store the number in. After the second memory location digit is entered, the unit will emit a warbled tone (a short series of beeps) to confirm successful programming and exit program mode.

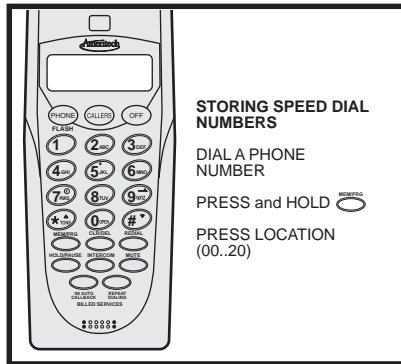

If programming is unsuccessful the unit will display:



PROGRAMMING
INCOMPLETE

Unsuccessful programming can result from not correctly completing the programming sequence. If this message appears, simply repeat the programming sequence.

- The number stored in memory location 00 can be accessed by pressing the one touch speed dial **(QUICK DIAL)** key on the Base Unit.

Dialing From Memory From the Handset

- Press **(PHONE)** to get a dial tone.
- Press **(MEM/PRG)**, you're prompted to enter a speed dial location number:



SPEED DIAL
LOCATION__

- Enter a 2 digit location number (00..20).
 - The number stored in that location will be displayed and immediately dialed.
- Or
- Beginning from the OFF mode, press **(MEM/PRG)** followed by a 2 digit location number (00..20).

MEMORY DIALING

- Press **MEM/PRG** again to exit memory dial mode and leave the number on the display.
- Press **PHONE**. The number on the display will be dialed after a 2 second pause.

• Note that if digits were on the display prior to entering memory dial mode, the contents of the speed dial memory will be appended to those digits. For example, if **1503** was on the display and the contents of the memory location is 5551212, then the display would show the following upon exiting memory dial mode:

1503555121
2

Changing Stored Numbers

To change or replace a stored number simply enter the new number on the display and store it in the memory location you wish to change.

Deleting Stored Numbers

- Press **MEM/PRG**. The display will change to "**SPEED DIAL LOCATION_ _**".
- Enter memory location number (00..20).
- Press **CLR/DEL** key. The display will change to "**LOCATION XX DELETED**".

LOCATION XX
DELETED

- Press **OFF** to exit.

NOTE:

Stored numbers are retained in memory even if the base loses its power or the handset battery is removed.

Storing Special Codes

To insert a pause in a phone number, press **HOLD/PAUSE** at the appropriate point when entering the number. This inserts a 2 second pause. A "P" appears in the display to show the pause. For longer pauses, press **HOLD/PAUSE** two or more times. Each press makes the pause 2 seconds longer and is treated as a stored digit.

If your phone is connected to a PBX, you can store the PBX access number and a pause before the phone number. For example, to store 9-PAUSE-555-1234 in memory location 08, do the following:

1. Press **9**
2. Press **HOLD/PAUSE**
3. Enter 5551234
4. Press and hold **MEM/PRG**
5. Enter 08



CALLER ID

Caller ID

Your **Ameritech AM 1930** cordless phone is capable of displaying the name and/or phone number of the person calling, before you answer the phone. Subscription to Caller ID service through your local phone company is required to utilize this feature.

If you subscribe to alphanumeric (name and number) Caller ID service, the calling party's name and phone number (when available) will be displayed on the handset screen while the phone is ringing.

If you subscribe to numeric (number only) Caller ID service, the calling party's phone number (when available) will be displayed on the handset screen while the phone is ringing.

Call Waiting Caller ID (Type II)

Your **Ameritech AM 1930** cordless phone is also capable of displaying Caller ID information in connection with a Call Waiting signal. If you are on a call, and receive a Call Waiting alert signal, the handset will display the name and/or number (when available) of the party trying to reach you. As above, subscription to Call Waiting ID service through your local phone company is required in order to utilize this feature.

A Word About Caller ID

Due to regional incompatibilities, Caller ID information may not be available for every call you receive. In addition, the calling party may intentionally block their name and phone number from being sent.

NOTE:

You must be in an area where Caller ID service is available and you must subscribe to it to use this feature.

If you do not subscribe to the Caller ID service, the phone will still operate normally, except that the Caller ID information is not received or displayed.

Receiving and Storing Calls

This unit receives and displays all Caller ID information: the caller's telephone number, the caller's name and the exact date and time of the call.

The phone sequentially numbers these call records and retains them in the unit's memory for later review. The unit can store up to 50 numbers in its memory.

Once the Caller ID memory is full, any new call forces a deletion of the oldest call record.

Dialing From Caller ID Memory

NOTE:

Only the last 7 digits of any number are displayed when dialing from Caller ID memory.

For example, when you press and hold the 7  key to view the phone number, you would see the following:





CALLER ID

However, when you dial directly from Caller ID memory, only the last 7 digits of the received telephone number will be used. Consequently, you would actually dial this:

5551212

The **Ameritech AM 1930** was designed to accommodate this situation. If you need to temporarily add a long distance prefix and /or area code (such as 1503) before the Caller ID number, do the following:

- Beginning from the standby mode, key in the necessary digits. Your display will look like this:

1503

- Then, to temporarily add the last 7 digits only from a Caller ID memory, press **CALLERS**.
- Using the **▲** (*) and **▼** (#) keys, scroll through the received calls to locate the number you wish to dial.
- Once you have located the number you wish to dial, simply press **PHONE**. The last seven digits will be added to the numbers already in the display, and the whole number shown below will be automatically dialed.

1503555121
2

Special Message Indicators Out of Area Calls

If for any reason the telephone number of the caller is unavailable, or if the caller is outside the Caller ID service area, the message UNAVAILABLE is displayed.

UNAVAILABLE

“Private” Calls

If the caller has exercised the option to block his or her number from being sent, then the display will show PRIVATE.

PRIVATE

Transmission Error

If an error is detected, then the Caller ID information is incomplete and will not be displayed. **TRANSMISSION ERROR** will be displayed.

TRANSMISSION
ERROR

The occasional appearance of **TRANSMISSION ERROR** on your display does not indicate a problem with your unit or your telephone line. However, if this appears frequently, you may want to notify your telephone company.



CALLER ID

Reviewing Numbers

Calls stored in memory can be reviewed by pressing **CALLERS**. The display will show the number of the most recent (Call #01). The top line of the display is used to indicate the memory location number and the bottom line of the display shows the name, see below:



There may be additional characters in the name which can not be shown on the current display. Press the **→** (9) key. This will overwrite the Caller ID memory location on the top line to show up to a maximum of 15 alpha characters for the duration of the key press. The first 12 alpha characters will be on the top line with up to 3 additional characters on the second line.



To find out the corresponding phone number as well as the date and time of the call, press and hold the **7** (🕒) key. The date and time will be shown. Releasing the key will again show the caller's name.



Pressing the **▲** (*) key displays the next lower in sequence call record. Likewise, pressing the **▼** (#) key displays the next higher in sequence call record. The higher the call number, the older the call.

To save you time in reviewing call records, you can “wrap-around” the call history log. For example, if you press the **▲** (*) key enough to scroll back to the first record, pressing it again will force the display to go to the very end of the call record.

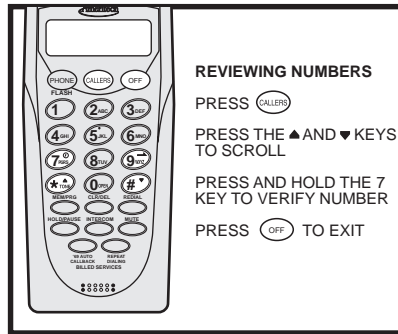

CALLER ID

Deleting Numbers

Pressing the **(CLR/DEL)** button deletes the Caller ID number displayed.

- While the phone is in Caller ID mode, press the **(CLR/DEL)** key once to delete the current call and the display will show:

DELETING
SINGLE CALL

- The older Caller ID records will be moved forward by one location .

- Press and hold the **(CLR/DEL)** key for more than 2 seconds to delete the entire contents of Caller ID memory. The display will show the following for a final confirmation, before the entire Caller ID memory is erased:

DELETE ALL?
DEL TO ALLOW

- Pressing **(CLR/DEL)** will confirm the operation and the display will then show:

DELETING
ALL CALLS

- The message will remain on the display for 2 seconds.
- Pressing any key other than **(CLR/DEL)** will cancel the operation.



ADDITIONAL OPERATING TIPS

Noise Or Interference

Your **Ameritech AM 1930** cordless telephone has auto-channel scan circuitry which will detect excess noise and change the channel of the phone to reduce it. This is done automatically.

Since the **Ameritech AM 1930** is a fully digital phone, it does not suffer from noise associated with regular cordless phones. At times you may experience occasional "drop outs", especially at the extreme edges of the phone's range. Simply move closer to the base unit and this will disappear.

Automatic Security Coding

Your **Ameritech AM 1930** phone is factory set with 16.8 million possible security codes. This unique security code allows your handset and base to recognize each other, and minimizes the possibility of another cordless phone using your telephone line.

Out Of Range indication

If the handset is moved to a point where the base and handset can no longer communicate, the handset will display **CHANNEL SEARCHING** and scan all channels in an attempt to re-link with the base.

**CHANNEL
SEARCHING ...**

Out Of Range When Phone Is On

If you are presently engaged in a phone conversation move closer to the base. If the base unit does not communicate with the handset within 25 seconds of losing contact, it will automatically hang up.

Out Of Range When Phone Is Off

When the phone is **OFF**, the handset and base still monitor each other to make sure that they can communicate. If the handset is moved out of range, the handset will display **CHANNEL SEARCHING**. The handset will scan all channels in an attempt to reestablish communication with the base. This process does not require user intervention; the handset will re-link with the base automatically once it is brought back within range. The unit will then be able to receive and place calls.





MAINTENANCE

Taking Care Of Your Telephone

Your **Ameritech AM 1930** cordless telephone contains sophisticated electronic parts, so it must be treated with care.

Avoid rough treatment

Place the handset down gently. Save the original packing materials to protect your telephone if you ever need to ship it.

Avoid water

Your telephone can be damaged if it gets wet. Do not use the handset outdoors in the rain, or handle it with wet hands. Do not install your base unit near a sink, bathtub or shower.

Electrical storms

Electrical storms can sometimes cause power surges harmful to electronic equipment.

For your own safety, use caution when using electric appliances during storms.

Cleaning your telephone

Your telephone has a durable plastic casing that should retain its luster for many years. Clean it only with a soft cloth slightly dampened with water or a mild soap. Do not use excess water or cleaning solvents of any kind.

Remember that electrical appliances can cause serious injury if used when you are wet or standing in water. If your base unit should fall into water, **DO NOT RETRIEVE IT UNTIL YOU UNPLUG THE POWER CORD AND TELEPHONE LINE CORDS FROM THE WALL.** Then pull the unit out by the unplugged cords.





IN CASE OF DIFFICULTY

If you have difficulty operating your phone, the suggestions below should solve the problem. If you still have difficulty after trying these suggestions, call Ameritech at 1-800-456-6858.

THE PHONE DOESN'T WORK AT ALL.

- Make sure the Power Cord is plugged in
- Make sure the telephone line cord is plugged firmly into the base unit and the telephone wall jack.
- Make sure the batteries are properly charged. If the 'LOW BATTERY' message is shown, the battery pack needs charging.

NO DIAL TONE.

- First check all the suggestions above.
- If you still don't hear a dial tone, disconnect the base unit from the telephone jack and connect a different phone. If there is no dial tone on that phone either, the problem is in your wiring or local service. Call your local telephone company.

YOU GET NOISE, STATIC, OR A WEAK SIGNAL EVEN WHEN YOU'RE NEAR THE BASE UNIT.

- Household appliances plugged into the same circuit as the base unit can sometimes cause interference. Try moving the appliance or the base unit to another outlet.

YOU GET NOISE, STATIC, OR A WEAK SIGNAL WHEN YOU'RE AWAY FROM THE BASE UNIT.

- You may be out of range. Either move closer to the base, or relocate the base unit.
- Raise the Base Unit antenna to an upright position, if the Base Unit is wallmounted, raise the antenna to point at the ceiling.
- The layout of your home may be limiting the range. Try moving the base unit to another position.

THE HANDSET DOES NOT RING WHEN YOU RECEIVE A CALL.

- Make sure you have the handset ringer activated. To set the ringer, see "PROGRAMMING THE RINGER".
- Make sure the telephone line cord is plugged firmly into the base unit and the telephone jack. Make sure the power cord is plugged in.
- You may be too far from the base unit.
- You may have too many extension phones on your telephone line to allow all of them to ring. Try unplugging some of the other phones.

YOU HEAR OTHER CALLS WHILE USING YOUR PHONE.

- Disconnect your base unit from the telephone jack, and plug in a regular telephone. If you still hear other calls, the problem is probably in your wiring or local service. Call your local telephone company.

YOU HEAR NOISE IN THE HANDSET, AND NONE OF THE KEYS OR BUTTONS WORK.

Make sure the power cord is plugged in.





IN CASE OF DIFFICULTY

COMMON CURE FOR ELECTRONIC EQUIPMENT

If the unit does not seem to be responding normally, then try putting the handset in the cradle. If it does not seem to respond after trying this a few times, do the following (in the order listed):

1. Disconnect the power to the base.
2. Disconnect the handset battery.
3. Wait a few minutes.
4. Connect power to the base.
5. Connect the handset battery.
6. Put the handset in the base.





WARRANTY

LIMITED WARRANTY

The Manufacturer warrants, to the original purchaser only, the material and workmanship of this product for **ONE YEAR** from the date of purchase. The manufacturer will repair or replace, at our option, this product without charge should it fail due to a defect in material or workmanship within that time period.

This warranty does not apply to loss or damage which is the result of accident, misuse or negligence. All other warranties, expressed, implied, or statutory, including warranties of fitness for a particular purpose, are limited to the time period listed and are otherwise excluded from this warranty. The manufacturer may, at its option, void the warranty if unauthorized repairs are attempted. Additionally, the manufacturer shall not be liable for any incidental or consequential damage or commercial loss, nor for any other loss or damages.

The manufacturer **assumes no responsibility for products sent without prior Return Authorization.**

To arrange for service, in or out of warranty, please call **AMERITECH** at 1-800-456-6858. **For warranty service, proof of purchase is required.**





TECHNICAL SPECIFICATIONS

FREQUENCY CONTROL

Crystal Controlled Dual POLL Synthesizer

TRANSMIT FREQUENCY

Handset : 925.05 MHz to 927.75 MHz
(All ten channels within this range)

Base : 902.3 MHz to 905.0 MHz
(All ten channels within this range)

RECEIVE FREQUENCY

Handset : 902.3 MHz to 905.0 MHz
(All ten channels within this range)

Base : 925.05 MHz to 927.75MHz
(All ten channels within this range)

NOMINAL EFFECTIVE RANGE

Maximum power allowed by FCC
Actual operating range may vary according to environmental conditions at the time of use.

SIZE

Handset : 19 x 6 x 3.5cm (L x W xT)
Maximum (Antenna excluded)

Base : 21.5 x 14.5 x 5cm (L x W x T) Maximum (Antenna excluded)

WEIGHT

Handset : 250 grams
Base : 415 grams

POWER REQUIREMENTS

Handset : Self-contained nickel-cadmium rechargeable battery supply, 3.6V nominal, 600mAh capacity.

Base: 9VDC @ 500mA

MEMORY

Speed Dial : 21 Memory locations,
20 digits per location.

Caller ID : Alphanumeric Display
50 Memory locations

SPECIFICATIONS ARE TYPICAL AND MAY CHANGE WITHOUT NOTICE.





INDEX

A
Answering Calls20,23

B
Backlighting2
Base Unit Features18
Base Unit Function Keys19
Battery Charging8
Battery, purchasing spare
or replacement10
Battery, replacing drained10
Billed Services Keys1,28

C
Call Waiting25
Caller ID, "Private" calls33
Caller ID, Deleting numbers35
Caller ID, Dialing from Caller ID
memory32
Caller ID, Reviewing numbers21,34
Caller ID, Transmission errors33
Clear/Delete function28
Customer Service40

D
Digital Security code2

E
Extension In Use Indication1,15

F
Face-up/Face down Charging2
FCC Regulations4
FLASH function19,23,25

G

H
Handset Display Examples14
Handset Layout16
Hold function20,22,24

I
In Case of Difficulty38
Installation11
Intercom20

J,K

L
LOW BATTERY message8,14

M
Maintenance37
Making Calls20

Memory Dialing19,20,21,30,31
Message Waiting Indication1,25
MUTE function14,18,19,20,23

N
NEW CALL message25
NiCad Battery8

O
Out of Range indication36

P
Parts Checklist3
Power Backup10
PRIVATE message33

Q
Quick Dial Key19,21,30

R
Redial19,22,28
Repair (see Service)
Ringer, base ON/OFF switch27
Ringer, changing types26
Ringer Equivalence Number (REN) .4,5
Ringer MUTE23
Ringer, programming26

S
Service40
Setup11,20
Spare Battery Charger10
Speakerphone19,21,23
Speed Dial Memory
(see Memory Dialing)

T
Technical Specifications41
Temporary Tone26
Tone/Pulse Switch11
Troubleshooting (see In Case of Difficulty)

U

V
Voicemail (see Message
Waiting Indication)
Volume Control, base19
Volume Control, handset16,23

W
Wall Mounting13
Warranty40

X,Y,Z





TABLE OF CONTENTS

| | Page |
|--|------|
| INTRODUCTION | 1 |
| Special Features | 2 |
| Parts Check List | 3 |
| FCC REGULATIONS | 4 |
| IMPORTANT SAFETY INSTRUCTIONS | 6 |
| REPLACING THE BATTERY PACK | 8 |
| GETTING STARTED | 11 |
| WALL MOUNTING | 13 |
| EXAMPLES OF THE HANDSET DISPLAY | 14 |
| THE HANDSET LAYOUT | 16 |
| THE BASE UNIT LAYOUT | 17 |
| BASE UNIT FEATURES | 18 |
| BASE UNIT FUNCTION KEYS | 19 |
| QUICK REFERENCE GUIDE | 20 |
| BASIC OPERATION | 23 |
| ADVANCED FUNCTIONS | 25 |
| Call Waiting | 25 |
| Switching Calls | 25 |
| Message Waiting Indication | 25 |
| Temporary Tone | 26 |
| Programming The Ringer | 26 |
| Changing Ringer Types | 26 |
| Clear/Delete (CLR/DEL) Key | 28 |
| Advanced Dialing | 28 |
| Multi Level REDIAL | 28 |
| Billed Services | 29 |
| MEMORY DIALING | 30 |
| Storing Memory Speed Dial Numbers | 30 |
| Dialing From Memory | 30 |
| Changing Stored Numbers | 31 |
| Deleting Stored Numbers | 31 |
| Storing Special Codes | 31 |
| CALLER ID | 32 |
| Call Waiting Caller ID (Type II CID) | 32 |
| A Word About Caller ID | 32 |
| Receiving and Storing Calls | 32 |
| Dialing From CALLER ID Memory | 32 |
| Special Message Indicators/Out Of Area Calls | 33 |
| "Private" Calls | 33 |
| Transmission Error | 33 |
| Reviewing Numbers | 34 |
| Deleting Numbers | 35 |
| ADDITIONAL OPERATING TIPS | 36 |
| MAINTENANCE | 37 |
| IN CASE OF DIFFICULTY | 38 |
| WARRANTY | 40 |
| TECHNICAL SPECIFICATIONS | 41 |
| INDEX | 42 |





Copyright 1998 for VTECH COMMUNICATIONS LTD..

91-5025-13-00
ISSUE 0

